



Premiere Series™



The **Premiere Series**™

INTRODUCTION

WELCOME BACK TO THE FUTURE:

The Premiere Series

OBJECTIVE:

Design-savvy, personalized private office furniture at an affordable price and high level of quality, delivered in 6 weeks or less.



The Premiere Series™

PRODUCT OVERVIEW

/ BRIEF OVERVIEW

Mini Statement of Line

- **Desks:** Rectangular, Arc, Corner, P-Top, D-Top, Table
- **Storage:** Peds, Credenza, Freestanding, Hutch, Corner Hutch, Stackers
- **Wall Boards:** fabric, whiteboard, rails and combos
- **Meeting Tables:** round and square
- **Round-disc base or square** (with or without metal base plate) 3" or 6" Black or silver, laminate box leg (with aluminum base trim)
- **Painted or frosted aluminum framed doors.**
Shaker-style laminate framed clear glass doors.
Sliding and solid laminate doors



The Premiere Series™

MAIN FEATURES

/ TO-THE-INCH

On Worksurfaces and Hutches





The Premiere Series™

MAIN FEATURES

/ 33 Laminate Colors

NEW Dark Suede & Sand Drift





The Premiere Series™

MAIN FEATURES

/ Solid Wood Edges

NEW Wavecrest™ Edge *(in addition to other options)*





The **Premiere Series**™

MAIN FEATURES

/ Over 20 Pull Choices

NEW Rover (wide and standard)





The Premiere Series™

MAIN FEATURES

/ Worksurface Shapes

NEW D-Top and Corner *(in addition to other shapes)*





The Premiere Series™

MAIN FEATURES

/ Metal Leg Designs

NEW Round with Disc Base and Square *(Silver & Black, 2 Sizes)*





The Premiere Series™

MAIN FEATURES

/ Box Leg

NEW Laminate Box (*silver base trim*)





The Premiere Series™

MAIN FEATURES

/ Painted Glass

NEW (*Broad range of standard colors*)

Custom Color



White

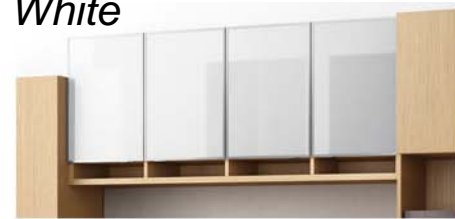

Custom Color



Graphite



Frosted



Black





The Premiere Series™

MAIN FEATURES

/ Mixed-Material

NEW (Fabrics, glass, metal trims and laminates)





The Premiere Series™

MAIN FEATURES

/ Textile Modesty Panels

NEW





The Premiere Series™

MAIN FEATURES

/ Frosted or Painted Modesty Panel

NEW Design





The Premiere Series™

MAIN FEATURES

/ Wall Boards

NEW (frameless wall mounted or hutch supported)





The Premiere Series™

MAIN FEATURES

/ Power Management

NEW (*Deluxe Cable Management*)





The **Premiere Series**™

MAIN FEATURES

/ Metal & Wood Framed Doors

NEW Slim Line Design





The Premiere Series™

MAIN FEATURES

/ Sliding Glass Doors

NEW





The Premiere Series™

MAIN FEATURES

/ Styling

From Classic (Function types) to Progressive

Classic



- >



Mid-Modern

Mid-Modern



- >



Progressive



The Premiere Series™

TYPICALS



Typical **311419**
List Price **\$5,953**

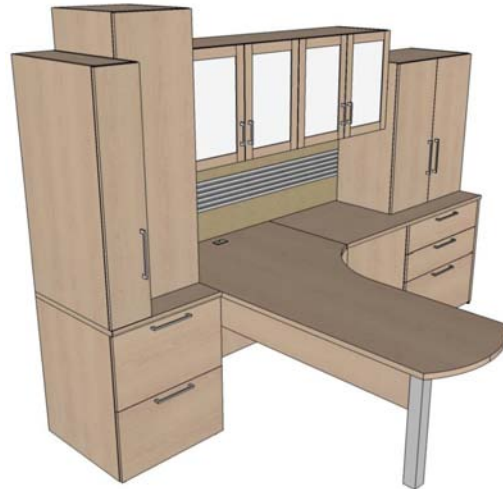

Typical **311432**
List Price **\$5,787**



Typical **311442**
List Price **\$5,114**



The Premiere Series™

TYPICALS



Typical **311435**
List Price **\$9,594**



Typical **311447**
List Price **\$7,982**



Typical **311440**
List Price **\$3,814**



The Premiere Series™

DESIGN & PLANNING

/ RED

Design Your Office at: www.three-h.com/red





The Premiere Series™

DESIGN & PLANNING

/ Customer Service Support

Three H's renowned customer service is there to assist with the specification and quotation of its products.

Simply email or fax your design specifications and our knowledgeable staff will work with you to create a solution.

Three H strives for a 24 hour turn around time on most requests and provides complete specifications including a bill of materials with 2D and 3D drawings.

The Three H web site includes a Dealer Login area with real-time information, including sales and order tracking.



The Premiere Series™

MARKETING ADVANTAGES

- New features are usually only found on high-end veneer lines like Touhy, Nucraft and Krug.
- Full line of 33 laminate choice and over 20 pull options. Now featuring design-forward, fine-grain patterns on new Dark Suede and Sand Drift laminates.
- Our quality and service beat out the Global and HON's . See Case Studies!



The **Premiere Series**™

BROCHURE & SPEC GUIDE

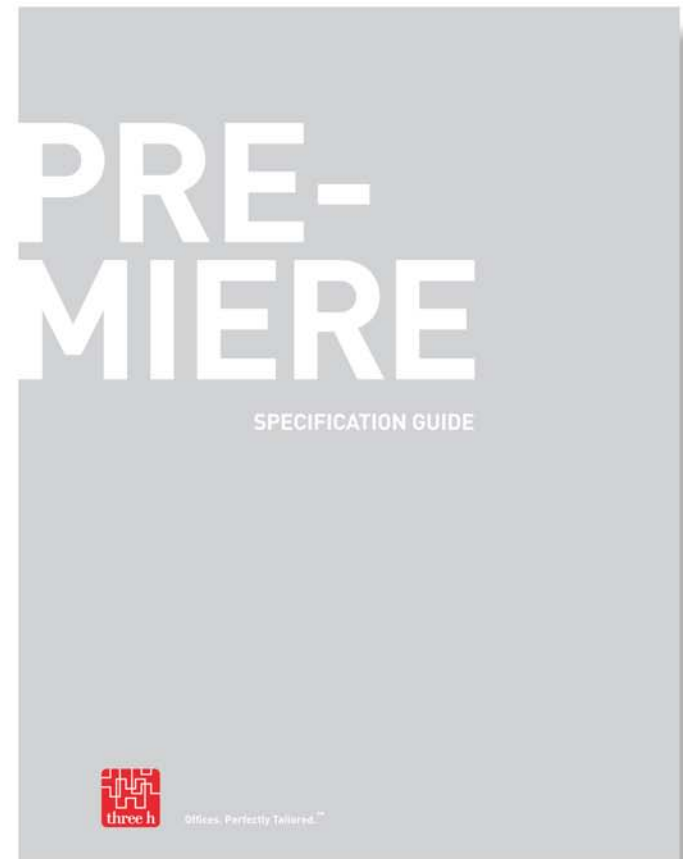



The Premiere Series™

3H ONLINE

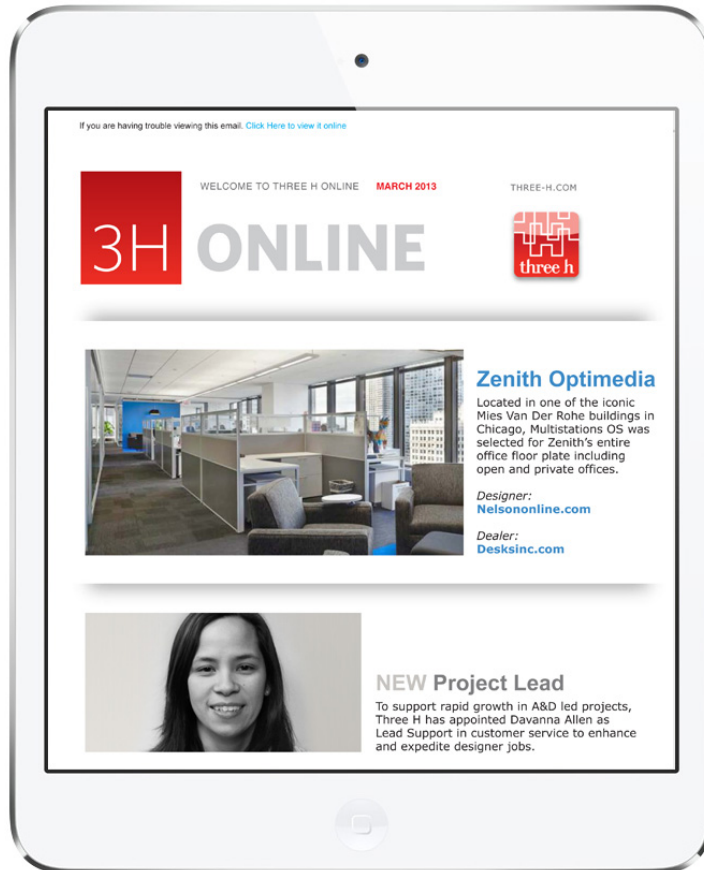



The Premiere Series™

CASE STUDIES

View more at: www.three-h.com/casestudies



Three H On Location

Seven Digital & Direct - Toronto, Ontario
For further information please visit us at www.three-h.com or contact us at 1-800-763-2299



Three H On Location

Amend - Stuy, Ohio
For further information please visit us at www.three-h.com or contact us at 1-800-763-2299



Three H On Location

Architects Plus - Cincinnati, Ohio
For further information please visit us at www.three-h.com or contact us at 1-800-763-2299





Offices. Perfectly Tailored.™